

## 2003 Montero Service Manual



Mitsubishi Motor Sales of America, Inc.  
Copyright 2002 - All Rights Reserved  
[www.mitsubishicars.com](http://www.mitsubishicars.com)

[VOLUME 1 \(00-13A\)](#)

[VOLUME 2 \(13B-26\)](#)

[VOLUME 3 \(27-52A\)](#)

[VOLUME 4 \(52B-54A\)](#)

[VOLUME 5 \(54B-90\)](#)

[INDEX](#)

[Technical Information Manual](#)

# GROUP 42

# BODY

## CONTENTS

|                                   |              |                                    |              |
|-----------------------------------|--------------|------------------------------------|--------------|
| <b>HOOD</b> .....                 | <b>42-3</b>  | <b>QUARTER WINDOW GLASS</b> ....   | 42-16        |
| <b>HOOD DIAGNOSIS</b> .....       | 42-3         | REMOVAL AND INSTALLATION.....      | 42-16        |
| INTRODUCTION TO HOOD DIAGNOSIS    | 42-3         | <b>BACK DOOR WINDOW GLASS</b> ..   | 42-18        |
| HOOD DIAGNOSTIC TROUBLESHOOTING   | 42-3         | REMOVAL AND INSTALLATION.....      | 42-18        |
| STRATEGY .....                    | 42-3         | <b>DOOR</b> .....                  | <b>42-20</b> |
| SYMPTOM CHART .....               | 42-3         | <b>GENERAL DESCRIPTION</b> .....   | 42-20        |
| SYMPTOM PROCEDURES .....          | 42-3         | <b>CENTRAL DOOR LOCKING SYSTEM</b> |              |
| <b>HOOD</b> .....                 | 42-5         | <b>DIAGNOSIS</b> .....             | 42-20        |
| REMOVAL AND INSTALLATION .....    | 42-5         | <b>POWER WINDOW DIAGNOSIS</b> ...  | 42-20        |
| INSPECTION.....                   | 42-7         | INTRODUCTION TO GLASS AND DOOR     |              |
| <b>FENDER</b> .....               | <b>42-7</b>  | DIAGNOSIS .....                    | 42-20        |
| REMOVAL AND INSTALLATION .....    | 42-7         | GLASS AND DOOR DIAGNOSTIC          |              |
| <b>FUEL FILLER LID</b> .....      | <b>42-8</b>  | TROUBLESHOOTING STRATEGY....       | 42-20        |
| REMOVAL AND INSTALLATION .....    | 42-8         | SYMPTOM CHART .....                | 42-21        |
| <b>WINDOW GLASS</b> .....         | <b>42-10</b> | SYMPTOM PROCEDURES.....            | 42-21        |
| <b>GENERAL DESCRIPTION</b> .....  | 42-10        | <b>HOW TO LOCATE WIND NOISES.</b>  | 42-24        |
| <b>WINDOW GLASS DIAGNOSIS</b> ... | 42-11        | <b>SPECIAL TOOLS</b> .....         | 42-25        |
| INTRODUCTION TO WINDOW GLASS      | 42-11        | <b>ON-VEHICLE SERVICE</b> .....    | 42-26        |
| DIAGNOSIS.....                    | 42-11        | DOOR FIT ADJUSTMENT .....          | 42-26        |
| WINDOW GLASS DIAGNOSTIC           | 42-12        | DOOR WINDOW GLASS ADJUSTMENT       | 42-26        |
| TROUBLESHOOTING STRATEGY ...      | 42-12        | DOOR INSIDE HANDLE PLAY CHECK AND  |              |
| SYMPTOM CHART .....               | 42-12        | ADJUSTMENT .....                   | 42-27        |
| SYMPTOM PROCEDURES .....          | 42-12        | DOOR OUTSIDE HANDLE PLAY CHECK     | 42-27        |
| <b>SPECIAL TOOLS</b> .....        | 42-12        | CIRCUIT BREAKER (INCORPORATED IN   |              |
| <b>WINDSHIELD</b> .....           | 42-13        | THE POWER WINDOW MOTOR)            |              |
| REMOVAL AND INSTALLATION .....    | 42-13        | INSPECTION .....                   | 42-27        |

Continued on next page

|  |              |   |              |
|--|--------------|---|--------------|
| <b>DOOR ASSEMBLY</b> .....   | 42-28        | <b>BACK DOOR HANDLE AND LATCH</b>                   | 42-53        |
| REMOVAL AND INSTALLATION .....                                     | 42-28        | REMOVAL AND INSTALLATION .....                      | 42-53        |
| INSPECTION .....   | 42-29        | INSPECTION .....                                    | 42-54        |
| <b>DOOR TRIM AND WATERPROOF FILM</b> .....                         | 42-30        | <b>KEYLESS ENTRY SYSTEM</b> ..                      | <b>42-54</b> |
| REMOVAL AND INSTALLATION .....                                     | 42-30        | <b>GENERAL DESCRIPTION</b> .....                    | 42-54        |
| INSPECTION .....   | 42-36        | <b>KEYLESS ENTRY SYSTEM DIAGNOSIS</b> .....         | 42-54        |
| <b>DOOR GLASS AND REGULATOR</b>                                    | 42-37        | <b>SPECIAL TOOLS</b> .....                          | 42-55        |
| REMOVAL AND INSTALLATION .....                                     | 42-37        | <b>ON-VEHICLE SERVICE</b> .....                     | 42-55        |
| INSPECTION .....   | 42-39        | HOW TO REPLACE THE TRANSMITTER BATTERY .....        | 42-55        |
| <b>DOOR HANDLE AND LATCH</b> ....                                  | 42-40        | ENABLING/DISABLING THE ANSWERBACK FUNCTION .....    | 42-55        |
| REMOVAL AND INSTALLATION .....                                     | 42-40        | SECRET CODE REGISTRATION METHOD .....               | 42-56        |
| INSPECTION .....   | 42-41        | KEYLESS ENTRY SYSTEM REMOVAL AND INSTALLATION ..... | 42-58        |
| <b>WINDOW GLASS RUNCHANNEL AND DOOR OPENING WEATHERSTRIP</b> ..... | 42-44        | <b>SUNROOF ASSEMBLY</b> .....                       | <b>42-58</b> |
| REMOVAL AND INSTALLATION <FRONT DOOR> .....                        | 42-44        | <b>GENERAL DESCRIPTION</b> .....                    | 42-58        |
| <b>BACK DOOR ASSEMBLY</b> .....                                    | <b>42-47</b> | <b>SUNROOF DIAGNOSIS</b> .....                      | 42-58        |
| <b>BACK DOOR DIAGNOSIS</b> .....                                   | 42-47        | <b>SPECIAL TOOLS</b> .....                          | 42-58        |
| INTRODUCTION TO BACK DOOR DIAGNOSIS .....                          | 42-47        | <b>ON-VEHICLE SERVICE</b> .....                     | 42-58        |
| BACK DOOR DIAGNOSTIC TROUBLESHOOTING STRATEGY .....                | 42-47        | WATER TEST .....                                    | 42-58        |
| SYMPTOM CHART .....  | 42-47        | SUNROOF FIT ADJUSTMENT .....                        | 42-59        |
| SYMPTOM PROCEDURES .....   | 42-48        | OPERATION CHECK .....                               | 42-59        |
| <b>SPECIAL TOOL</b> .....  | 42-49        | <b>SUNROOF ASSEMBLY</b> .....                       | 42-61        |
| <b>ON-VEHICLE SERVICE</b> .....                                    | 42-49        | REMOVAL AND INSTALLATION .....                      | 42-61        |
| BACK DOOR FIT ADJUSTMENT .....                                     | 42-49        | INSPECTION .....                                    | 42-64        |
| BACK DOOR HANDLE PLAY CHECK ..                                     | 42-49        | DISASSEMBLY AND ASSEMBLY .....                      | 42-65        |
| <b>BACK DOOR ASSEMBLY</b> .....                                    | 42-50        | <b>SPECIFICATIONS</b> .....                         | <b>42-68</b> |
| REMOVAL AND INSTALLATION .....                                     | 42-50        | FASTENER TIGHTENING SPECIFICATIONS .....            | 42-68        |
| INSPECTION .....   | 42-51        | SERVICE SPECIFICATIONS .....                        | 42-68        |
| <b>BACK DOOR TRIM AND WATERPROOF FILM</b> .....                    | 42-52        | SEALANTS .....                                      | 42-68        |
| REMOVAL AND INSTALLATION .....                                     | 42-52        | COMPONENT IDENTIFICATION .....                      | 42-69        |

# HOOD

## HOOD DIAGNOSIS

### INTRODUCTION TO HOOD DIAGNOSIS

M1421005800040

Wind noise at the hood may be caused by improper hood adjustment.

### HOOD DIAGNOSTIC TROUBLESHOOTING STRATEGY

M1421005900036

Use these steps to plan your diagnostic strategy. If you follow them carefully, you will be sure that you have exhausted most of the possible ways to find a hood fault.

1. Gather information from the customer.

2. Verify that the condition described by the customer exists.
3. Find the malfunction by following the Symptom Chart.
4. Verify malfunction is eliminated.

### SYMPTOM CHART

M1421006000337

| SYMPTOM                         | INSPECTION PROCEDURE | REFERENCE PAGE |
|---------------------------------|----------------------|----------------|
| Difficult locking and unlocking | 1                    | P.42-3         |
| Uneven body clearance           | 2                    | P.42-4         |
| Uneven height                   | 3                    | P.42-4         |

### SYMPTOM PROCEDURES

#### INSPECTION PROCEDURE 1: Difficult Locking and Unlocking

##### DIAGNOSIS

**STEP 1. Check the release cable routing condition.**

**Q: Is the release cable routing condition good?**

**YES :** Go to Step 2.

**NO :** Repair the release cable, then go to Step 4.

**STEP 2. Check the engagement of the hood latch and hood striker.**

**Q: Are the hood latch and hood striker engaged correctly?**

**YES :** Go to Step 3.

**NO :** Adjust the hood latch (Refer to P.42-5). Then go to Step 4.

**STEP 3. Check for proper lubrication of release cable.**

**Q: Is the release cable properly lubricated?**

**YES :** Go to Step 4.

**NO :** Lubricate, then go to Step 4.

**STEP 4. Retest the system.**

**Q: Does the hood lock operate easily?**

**YES :** The procedure is complete.

**NO :** Return to Step 1.

**INSPECTION PROCEDURE 2: Uneven Body Clearance**

---

**DIAGNOSIS****STEP 1. Check the hood installation condition.****Q: Is the hood installation in good condition?****YES :** Go to Step 2.**NO :** Adjust the hood (Refer to [P.42-5](#)). Then go to Step 2 .**STEP 2. Retest the system.****Q: Is the clearance with the body even?****YES :** The procedure is complete.**NO :** Return to Step 1.

---

**INSPECTION PROCEDURE 3: Uneven Height**

---

**DIAGNOSIS****STEP 1. Check the hood bumper height.****Q: Is the hood bumper height proper?****YES :** Go to Step 2.**NO :** Adjust the hood bumper (Refer to [P.42-5](#)). Then go to Step2.**STEP 2. Retest the system.****Q: Are the hood and body height even?****YES :** The procedure is complete.**NO :** Return to Step 1.

**HOOD  
REMOVAL AND INSTALLATION**

M1421001600226

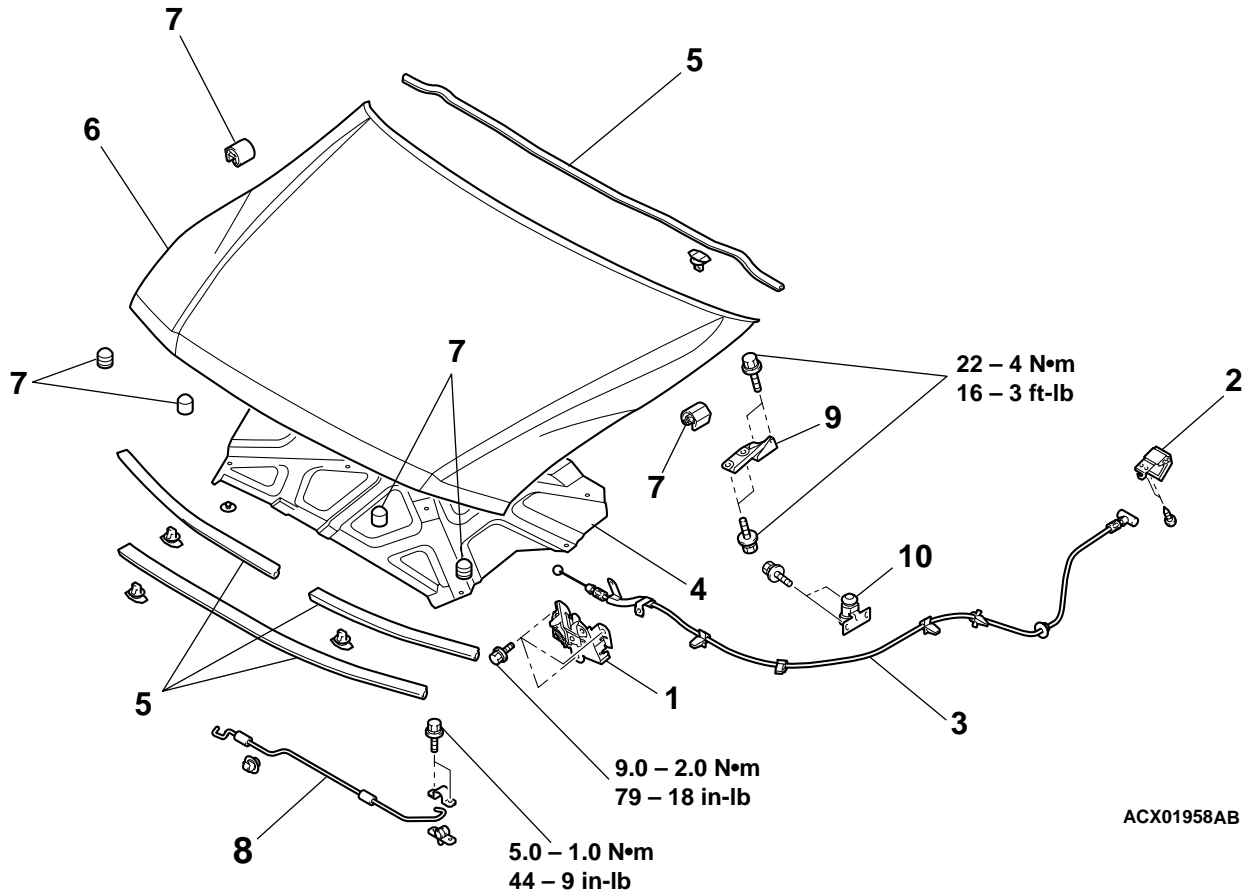

ACX01958AB

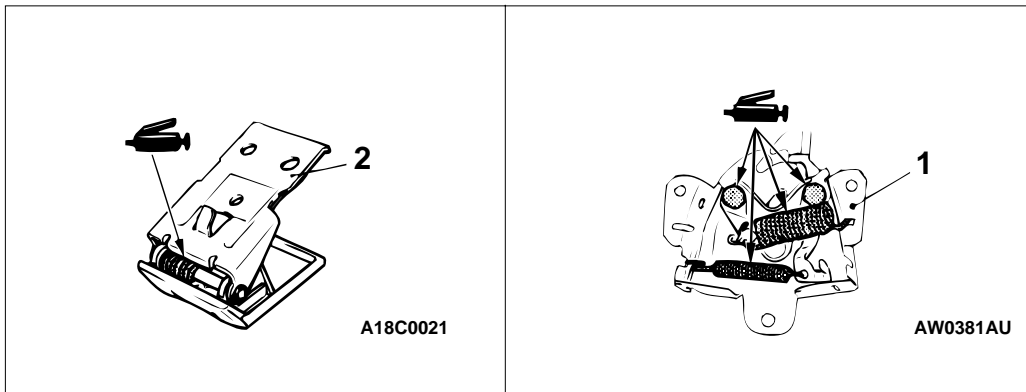

**HOOD LATCH REMOVAL STEPS**

- RADIATOR GRILL (REFER TO GROUP 51 – FRONT BUMPER P.51-3)

1. HOOD LATCH

**HOOD LOCK RELEASE CABLE  
REMOVAL STEPS**

2. HOOD LOCK RELEASE HANDLE  
3. HOOD LOCK RELEASE CABLE

**HOOD AND HOOD HINGE  
REMOVAL STEPS**

4. HOOD INSULATOR  
5. HOOD WEATHERSTRIP

**HOOD AND HOOD HINGE  
REMOVAL STEPS (Continued)**

- WASHER HOSE (REFER TO GROUP 51 – WINDSHIELD WIPER AND WASHER P.51-21)

6. HOOD

7. BUMPER A

8. HOOD SUPPORT ROD

- FRONT DECK GARNISH (REFER TO GROUP 51 – WINDSHIELD WIPER AND WASHER P.51-21)

9. HOOD HINGE

10. HOOD SWITCH

ADJUSTMENT OF CLEARANCE AROUND HOOD

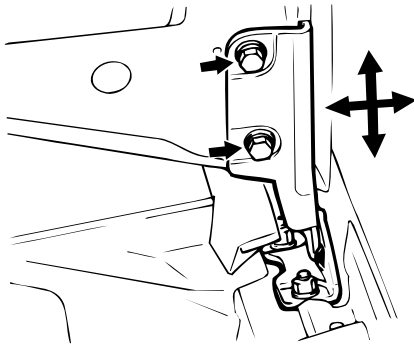

ACX00459

ADJUSTMENT OF HEIGHT AROUND HOOD

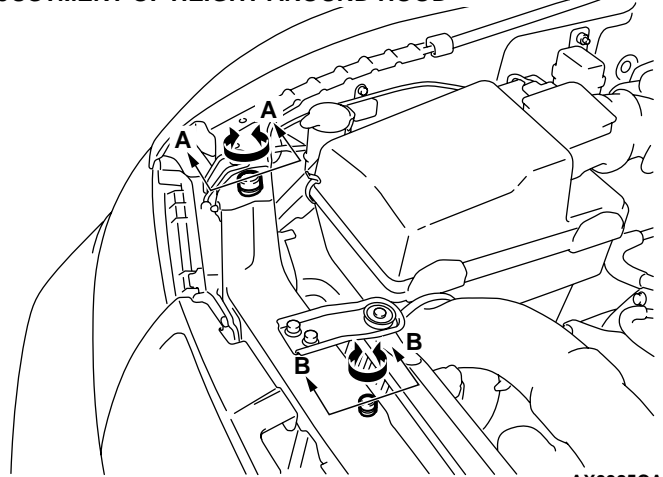

AX0385CA

ADJUSTMENT OF HOOD AND HOOD STRIKER ENGAGEMENT

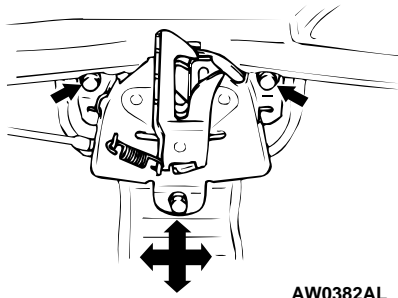

AW0382AL

SECTION A A

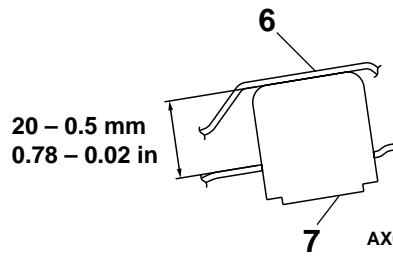

AX0424CA

SECTION B B

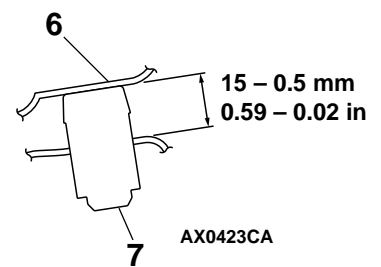

AX0423CA

CLIP POSITIONS

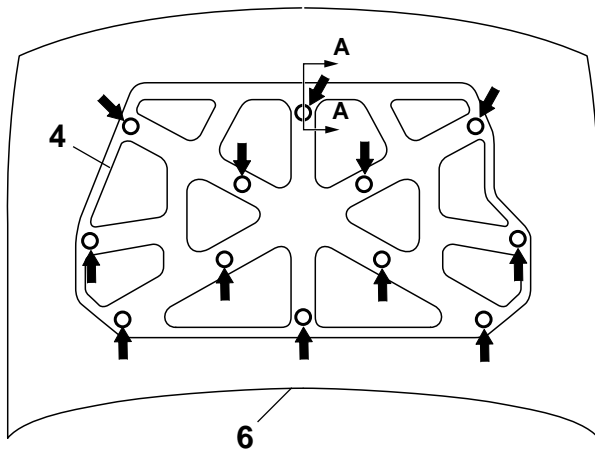

SECTION A A

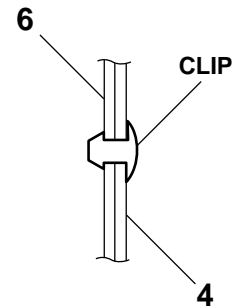

← : CLIP POSITION

AC203663AB

**INSPECTION**

M1421001700182

**HOOD SWITCH CONTINUITY CHECK <VEHICLES WITH THEFT-ALARM SYSTEM>**

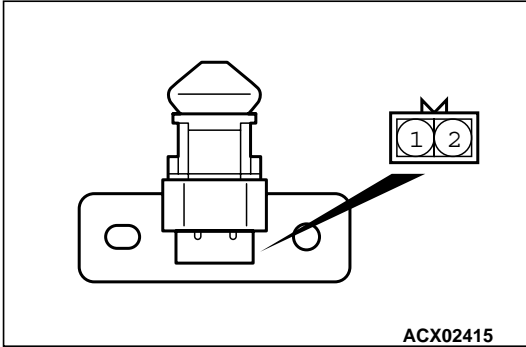

| SWITCH POSITION       | TESTER CONNECTION | SPECIFIED CONDITION |
|-----------------------|-------------------|---------------------|
| Hood switch unpressed | 1 – 2             | Less than 2 ohms    |
| Hood switch depressed |                   | Open circuit        |

**FENDER**

**REMOVAL AND INSTALLATION**

M1421001900216

**Pre-removal and Post-installation Operation**

- Front Bumper Removal and Installation (Refer to GROUP 51, Front Bumper P.51-3.)
- Front Mud Guard Removal and Installation (Refer to GROUP 51, Front Mud Guard P.51-16.)
- Front Wheel Cut Molding Removal and Installation (Refer to GROUP 51, Front Wheel Cut Molding P.51-9.)

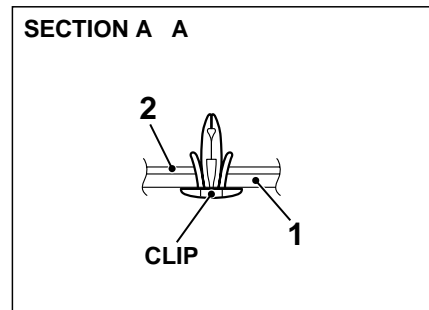
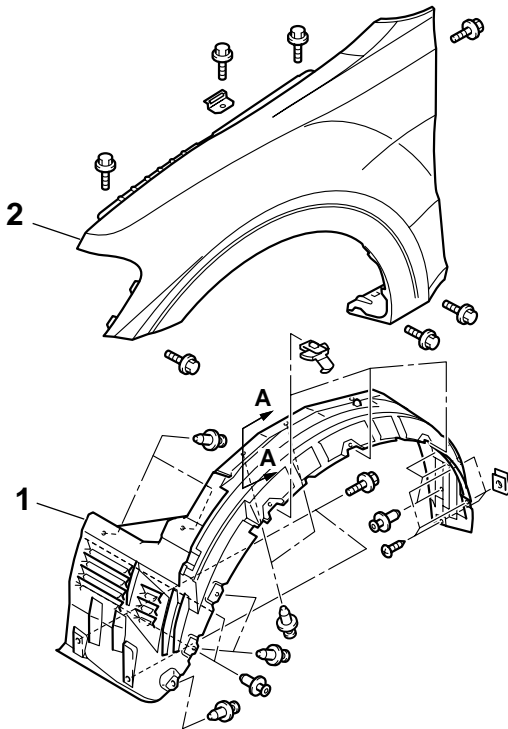

**REMOVAL STEPS**

1. SPLASH SHIELD
2. FENDER

AC203222AB



## FUEL FILLER LID

## REMOVAL AND INSTALLATION

M1421002500040

**Pre-removal and Post-installation Operation**

- Quarter Trim Lower Removal and Installation (Refer to GROUP 52A, Trims P.52A-8.)
- Center Pillar Trim Lower Removal and Installation (Refer to GROUP 52A, Trims P.52A-8.)

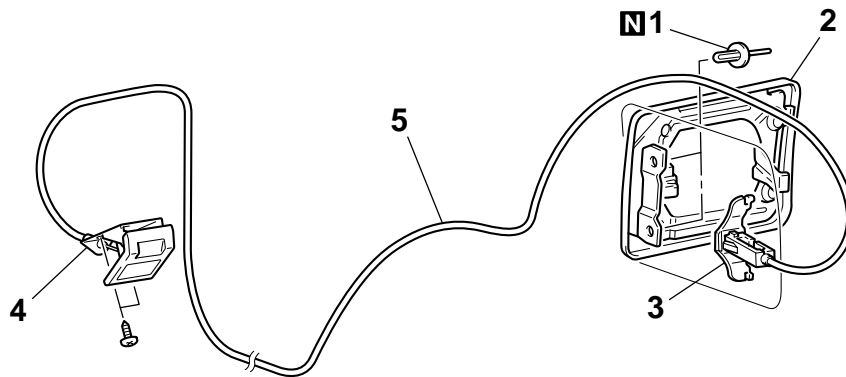

X0181CA

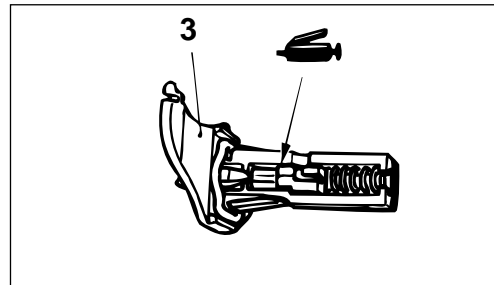

AC101963 AB

&lt;&lt;A&gt;&gt; &gt;&gt;A&lt;&lt;

**REMOVAL STEPS**

1. RIVET
2. FUEL FILLER DOOR PANEL ASSEMBLY
3. FUEL FILLER DOOR HOOK ASSEMBLY
4. LID LOCK RELEASE HANDLE

**REMOVAL STEPS (Continued)**

- INSTRUMENT LOWER PANAL (REFER TO GROUP 52A – INSTRUMENT PANEL P.52A-2.)
- 5. FUEL FILLER DOOR LOCK RELEASE CABLE

## REMOVAL SERVICE POINT

### <<A>> RIVET REMOVAL

Use a drill [ $\phi 6.5 - 7.5$  mm ( $\phi 0.25 - 0.29$  inch)] to break the rivet by drilling a hole, and remove the rivet.

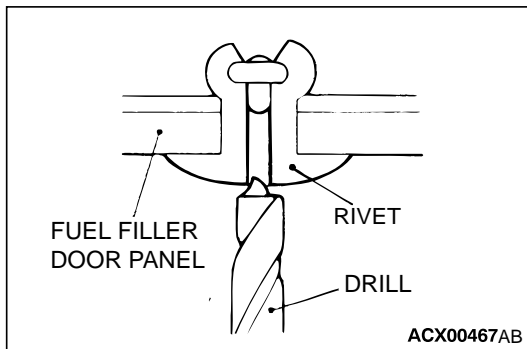

## INSTALLATION SERVICE POINT

### >>A<< RIVET INSTALLATION

1. Insert the rivet [ $\phi 6.4$ mm ( $\phi 0.25$  inch)] into the body panel and wide fender.
2. Insert the "A" side of the rivet into the riveter.
3. Pressing the flange surface of the rivet, move the handle of the riveter.
4. The thinnest point of "A" is cut and the rivet is held in the position.

