

Layout of the exploded diagram

**A** 34 **B** Manual Transmission, Controls, Case **C** 911 Carrera 4

Disassembling and assembling transmission

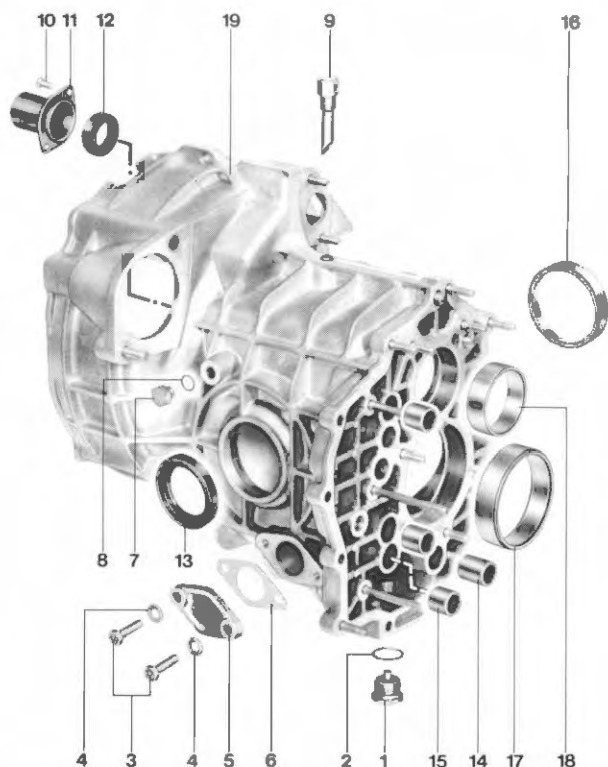

34 - 128 **D** Disassembling and assembling transmission **E** Printed in Germany - VI, 1988 **F**

**C** 911 Carrera 4 **B** Manual Transmission, Controls, Case **A** 34

No	Description	Qty.	Note when:	
			Removing	Installing
1	Screw plug	1		Clean, tighten with 30 Nm
2	Sealing ring	1		Replace
3	Hexagon head screw	2		Tighten with 23 Nm (17 ftlb)
4	Washer	2		
5	Flange	1		
6	Seal	1		Replace
7	Screw plug	1		Tighten with 23 Nm (17 ftlb)
8	Sealing ring	1		Replace
9	Breather	1		Tighten with 35 Nm (26 ftlb). Observe installation position
10	Fillister head screw	2		Tighten with 10 Nm (7 ftlb)
11	Guide tube	1		
12	Rotary shaft seal	1		Only install after assembling the gear set (also refer to Page 34-113)
13	Rotary shaft seal	1		Drive into position with Special Tool 9252. Pack space between sealing lips with Klüber Silubrin Grease S
14	Spherical sleeve	1	Pull out with a suitable internal puller (e.g. Schrem 14-20)	Press in with Special Tool 9254

Disassembling and assembling transmission **F** **E** **D** 34 - 129

- A - Repair group, numbers
- B - Repair groups, text
- C - Type of vehicle to be repaired
- D - Page number
- E - Operation
- F - Impressum, supplement number, year of printing
- G - Diagram item number in the order of disassembling
- H - Special notes to be observed when installing or removing

The notes on assembly/application of special tools which are given after the exploded diagram are always arranged in the order of text → diagram.

This workshop manual describes all of the important operations for which special instructions are required to assure proper completion. This manual is essential for the shop foremen and mechanics, who need this information to keep the vehicles in a safe operating condition. The basic safety rules, of course, also apply to repairs on vehicles without exception.

The information is grouped according to repair numbers which are identical to the first two digits of the repair time and warranty code.

The repair group index, an alphabetical index and the register table are quick guides to find information in the manual.

Descriptions of design and function can be found in the service training course reference material.

This workshop manual will be kept up to date with workshop bulletins, which will be made part of the manual from time to time. We recommend that these workshop bulletins be filed in the special folder provided for this purpose.

SUPPLEMENT TO 928 REPAIR MANUAL  
(XVIII)

Information Sheet - Extension of the 928 Repair Manual to 7 Volumes

Overview of Repair Manual Volumes:

Volume	I	= Drive Unit
Volume	I - A	= Drive Unit
Volume	II	= Drive Train
Volume	III	= Drive Train
Volume	IV	= Chassis, Heating, Air Conditioning
Volume	V	= Bodywork, Car Electrics
Volume	VI	= Car Electrics (Circuit Diagrams)
Volume	VII	= Car Electrics (Circuit Diagrams, '88 Models Onward)

Please file the pages in the volumes of the Repair Manual as follows:

1. Please file pages 20 - 1 to 28 - 71 of the original Volume I - Drive Unit in the new Volume I-A - Drive Unit.
  2. The new Volume VII Car Electrics (Circuit Diagrams, '88 Models Onward) contains pages 97 - 281 to 97 - 305.
-

# List of Repair Groups

<b>General</b>	Technical Data	Page 0.1
<b>Repair Groups</b>		<b>Group</b>
	Maintenance, Self-diagnosis	03
Engine	Engine, Crankcase	10
	Engine, Crankshaft, Pistons	13
	Engine, Cylinder Head and Valve Drive	15
	Engine, Lubrication	17
	Engine, Cooling	19
	Fuel Supply	20
	Air Flow Controlled Fuel Injection	24
	Exhaust System/Emission Controls	26
	Starter, Power Supply, Cruise Control	27
	Ignition System	28
Transmission	Clutch, Controls	30
	Torque Converter	32
	Manual Transmission, Controls, Case	34
	Manual Transmission, Gears, Shafts	35
	Automatic Transmission, Controls, Case	37
	Automatic Transmission, Gears, Valve Body	38
	Differential, Transaxle System	39
<b>Chassis</b>	Front Wheel Suspension	40
	Rear Wheel Suspension, Axle Shaft	42
	Wheels, Tires, Alignment	44
	Antiblock System	45
	Brakes, Mechanical	46
	Brakes, Hydraulics	47
	Steering	48
Body	Body-Front Section	50
	Body-Center Section	51
	Body-Rear Section	53
	Lids	55
	Doors	57
	Hardtop	61
	Bumpers	63
	Glasses, Window Control	64
	Exterior Equipment	66
	Interior Equipment	68
	Seats	72
	Seat Covers	74
Heating,	Heater	80
<b>Ventilation,</b>	Ventilation	85
<b>Air Condition</b>	Air Conditioner	87
Electrics	Instruments, Fuel Gauge, Alarm System	90
	Radio	91
	Windshield Wipers and Washer	92
	Exterior Lights, Lamps, Switches	94
	Interior Lights	96
	Wiring	97

	Page
<b>General</b>	
International Unit System . . . . .	.0-01
Lifting Car . . . . .	.0-1
Technical Data, General . . . . .	.0-3
Technical data - Type 928 GT - 89 model . . . . .	.0-35
Technical Data - Type 928 GTS - 1992 Model Year . . . . .	.0-36
<b>Maintenance, Self-diagnosis</b>	
LH/EZK control unit error diagnosis . . . . .	.03-1
Connection in the 928 S 4 . . . . .	.03-3
Starting error diagnosis . . . . .	.03-5
Functional check of actuator and input signals . . . . .	.03-7
Test code list . . . . .	.03-13
System adaption . . . . .	.03-15
Knock detection . . . . .	.03-17
Trouble-shooting . . . . .	.03-19
Error code list for the LH control unit . . . . .	.03-27
Trouble-shooting, EZK control unit . . . . .	.03-29
Error code list for the EZK control unit . . . . .	.03-37
Resetting the error memory . . . . .	.03-39
Operating instructions for system tester 9288 . . . . .	.03-41
<b>Engine / Crankcase</b>	
Tolerances and wear limits . . . . .	.10-01
Technical data . . . . .	.10-02a
Engine torque specifications . . . . .	.10-03
Removing and installing engine . . . . .	.10-1
Engine, removing and installing . . . . .	.10-11
<b>Engine, Crankshaft, Pistons</b>	
Tools . . . . .	.13-1
Engine support (special tool 9188) . . . . .	.13-2
Crankcase tools . . . . .	.13-3
Disassembling and assembling crankcase and crankshaft . . . . .	.13-4
Sealing upper and lower crankcase sections . . . . .	.13-7
Checking crankshaft bearing clearance . . . . .	.13-8
Installing crankshaft oil seals . . . . .	.13-9
Installing upper and lower crankcase sections . . . . .	.13-10
Machining flywheel . . . . .	.13-10b
Machining flywheel - 1984 models . . . . .	.13-10b

	Page
Removing and installing flywheel . . . . .	13-11
Removing and installing pilot bearing . . . . .	13-11
Disassembling and assembling pistons and connecting rods . . . . .	13-13
Installing piston and connecting rod . . . . .	13-15
Tolerance group of pistons and cylinders . . . . .	13-16
Checking connecting rod bearing clearance . . . . .	13-16
Replacing belts for air pump, alternator and power steering pump . . . . .	13-17
Checking and adjusting belt tightness . . . . .	13-18
Checking and adjusting tension of alternator poly-rib-belt . . . . .	13-18b
Replacing drive belts for alternator, power pump air, pump and A/C compressor . . . . .	13-18c
Crankshaft tools . . . . .	13-19
Installing flywheel stop . . . . .	13-20
Crankshaft journal sizes . . . . .	13-21
Checking piston and cylinder bore . . . . .	13-23
Piston arrangement . . . . .	13-24a
Piston sizes, 84/85/86 models onward . . . . .	13-24b
Notes for installing pistons (32 valve engines) . . . . .	13-24c
Pistons, 87 models onward . . . . .	13-24c
Checking pistons and cylinder bores (32-valve engines) . . . . .	13-24d
Checking pistons and cylinder bores - Type 928 GTS (5,4 l) . . . . .	13 - 24e
Remachining cylinder bores . . . . .	13-25

## Engine, cylinder head, valves

Valve tools . . . . .	15-1
Disassembling and assembling valve drive . . . . .	15-3
Checking end play of camshaft . . . . .	15-6f
Camshaft survey . . . . .	15-6g
Disassembling and assembling valve train . . . . .	15-7
Disassembling and assembling valve drive . . . . .	15-8
Machining valve seats . . . . .	15-8a
Checking valve guides . . . . .	15-8a
Removing and installing valve springs . . . . .	15-8b
Checking and installing length of valve springs . . . . .	15-8b
Removing and installing camshaft drive belt and water pump . . . . .	15-9
Installing camshaft drive belt and adjusting timing . . . . .	15-14
Drive belts with HTD teeth (beginning with 1983 models) . . . . .	15-16
Checking and adjusting drive belt . . . . .	15-17
Machining cylinder head . . . . .	15-19
Disassembling and assembling tensioning roller housing . . . . .	15-20
Bleeding tensioning roller housing (from 1983 models) . . . . .	15-23
Disassembling and assembling tensioning roller housing . . . . .	15-24

	Page
Cylinder head tools . . . . .	15-27
Replacing valve guides . . . . .	15-28
Checking TDC marks on camshaft sprockets . . . . .	15-31
Tools (32 valve engine) . . . . .	15-101
Checking and adjusting toothed belt . . . . .	15-102
Replacing toothed belt . . . . .	15-105
Tools - cylinder head (32 valve engines) . . . . .	15-109
Disassembling and assembling cylinder head . . . . .	15-110
Tools - cylinder head (32-valve engines) . . . . .	15-112
Tools - cylinder head, removing and installing valve springs . . . . .	15-112a
Removing and installing valve springs . . . . .	15-112b
Removing and installing valve stem seal . . . . .	15-112b
Installing valve stem seal, '87 models onward . . . . .	15-112c
Checking valve guides . . . . .	15-112d
Cylinder head - Tools replacing valve guides . . . . .	15-112e
Machining cylinder-head mating face . . . . .	15-112j
Checking valve seat wear limit . . . . .	15-113
Checking and machining valve seats . . . . .	15-114
Valve dimensions 928 S '85/'86 models onward . . . . .	15-115
Checking and adjusting installation length of valve springs (32-valve engines) . . . . .	15-116
Tools-Installing cylinder head . . . . .	15-116d
Modifications to the cylinder head (32 valve) . . . . .	15-116e
Cylinder head, installing . . . . .	15-117
Tools - Disassembling and assembling valve drive . . . . .	15-119
Disassembling and assembling valve drive . . . . .	15-120
Camshaft installation overview . . . . .	15-124
Camshaft installation overview Type 928 S4, 928 GTS (5,4 l) . . . . .	15-124a
Removing and installing camshafts . . . . .	15-125
Installing camshaft seal . . . . .	15-128a
Removing and installing chain tensioner for camshafts . . . . .	15-129
Camshaft setting, checking and adjusting . . . . .	15-131
Cylinder head cover, dismantling and reassembling . . . . .	15-137
928 S4 Club Sport-Version . . . . .	15-139
Camshaft installation . . . . .	15-140
Checking and/or adjusting camshaft settings . . . . .	15-141
Checking and/or adjusting camshaft settings, Type 928 GTS (5,4 l) . . . . .	15-142

**Engine, Lubrication**

Removing and installing lubricating system parts . . . . .	17-1
Oil pump, removing and installing . . . . .	17-6
Replacing shaft seal for oil pump . . . . .	17-6a
Lubrication system components, removing and installing . . . . .	17-6b
Changing engine oil and engine oil filter . . . . .	17-7
Checking oil pressure . . . . .	17-8
Checking oil pressure . . . . .	17-9
Cleaning oil check valve for hydraulic valve tappets . . . . .	17-10
Cleaning of engine-oil system . . . . .	17-11

**Engine, Cooling**

Changing coolant and bleeding cooling system . . . . .	19-1
Changing coolant and bleeding cooling system . . . . .	19-2
Checking coolant system cap . . . . .	19-2a
Checking coolant thermostat . . . . .	19-2b
Disassembling and assembling visco fan . . . . .	19-3
Disassembling and assembling thermostat housing for cooling system (ATF) . . . . .	19-6
Disassembling and assembling thermostat housing for cooling system . . . . .	19-8
Disassembling and assembling thermostat housing for cooling system - Notes . . . . .	19-10
Cooling-air flap control, '87 models onward . . . . .	19-11
Tightening torques, overview . . . . .	19-11
Function charts . . . . .	19-15
Removing and installing cooling-air flap motor . . . . .	19-19
Removing and installing fans . . . . .	19-20
Removing and installing cooling-air flaps . . . . .	19-21
Troubleshooting . . . . .	19-22
Function-testing senders . . . . .	19-23
Function-testing flap positioning motor . . . . .	19-24
Function-testing the output stage . . . . .	19-25



	Page
<b>Fuel supply</b>	
Replacing fuel filter - up to 1980 models . . . . .	20-1
Removing and installing fuel pump . . . . .	20-2
Checking delivery rate of fuel pump - CIS . . . . .	20-3
Checking fuel pump delivery - AFC . . . . .	20-4
Checking fuel pump delivery - LH-Jetronic, beginning with 1984 models . . . . .	20-5
Hose diagram for CIS . . . . .	20-6
Arrangement of check valves . . . . .	20-8
Replacing check valve . . . . .	20-9
Disassembling and assembling accelerator pedal . . . . .	20-10
Removing and installing fuel tank . . . . .	20-12
Removing and installing fuel intank (Japan) . . . . .	20-14
Fuel level sensor, removing and installing . . . . .	20-15
Activated charcoal cannister for removal of tonix substances . . . . .	20-17
form fuel tank breather (diagram)	
Calibrating the tank sensor system for model 89 onwards . . . . .	20-19
 <b>Electronic fuel injection</b>	
AFC equipment table . . . . .	24-01
Testing and adjusting specifications . . . . .	24-1
Adjusting idle - USA and Japan . . . . .	24-3
Adjusting idle speed and CO - USA and Japan, 1983 models . . . . .	24-6a
Checking fuel pressure . . . . .	24-27
Removing and installing pressure regulator . . . . .	24-9
Removing and installing intake air sensor . . . . .	24-9
Removing and installing cold start valve . . . . .	24-10
Removing and installing auxiliary air regulator . . . . .	24-10
Removing and installing temperature sensor II . . . . .	24-11
Removing and installing pressure damper . . . . .	24-11
Removing and installing fuel injectors . . . . .	24-12
Disassembling / assembling fuel injector . . . . .	24-13
Removing and installing fuel injectors . . . . .	24-13
Removing and installing throttle housing . . . . .	24-14
Checking and adjusting microswitches on throttle housing . . . . .	24-15
Checking temperature sensor II . . . . .	24-17
Checking temperature time switch (for cold start valve) . . . . .	24-17
Checking auxiliary air regulator . . . . .	24-18
Checking cold start valve . . . . .	24-18
Checking vacuum control . . . . .	24-19
Checking pressure regulator . . . . .	24-19
Checking air flow sensor . . . . .	24-20
Checking pressure regulator . . . . .	24-20

	Page
Troubleshooting AFC . . . . .	24-21
Hose Diagram for AFC . . . . .	24-22
Correcting CO level on air flow sensor . . . . .	24-24
LH-Jetronic equipment table . . . . .	24-101
LH-Jetronic air flow . . . . .	24-102
LH-Jetronic . . . . .	24-104
Troubleshooting LH-Jetronic . . . . .	24-108
Testing oxygen sensor operation . . . . .	24-120a
Testing and adjusting specifications . . . . .	24-121
Adjusting idle and CO, 1984 models . . . . .	24-122
Removing and installing heated wire air flow sensor . . . . .	24-125
Removing and installing fuel cooler . . . . .	24-126
Specifications for testing and adjusting . . . . .	24-201
Equipment chart - LH-Jetronic . . . . .	24-202
Adjusting idle . . . . .	24-203
Correcting CO adjustment on air volume sensor . . . . .	24-207
Fuel path - LH-Jetronic . . . . .	24-208
Injection valves, removing and installing . . . . .	24-209
Testing and adjustment values for Type 928 S4 - 928 GT - 928 GTS (5,4 l) . . . . .	24-211
Equipment chart - LH-Jetronic . . . . .	24-212
Checking idle, USA cars and cars with catalytic converters . . . . .	24-213
Adjusting idle without catalytic converter . . . . .	24-214
Fuel path, LH-Jetronic . . . . .	24-216
Modified breather for crankcase and cylinder heads . . . . .	24-218
Testing oxygen sensor operation . . . . .	24-219
Testing oxygen sensor operatio . . . . .	24-221
Coding for LH control unit . . . . .	24-222
Removing and installing rotary idle actuator . . . . .	24-223

## Fuel mixture

Tightening torque for fuel system . . . . .	25-01
Replacing air cleaner element . . . . .	25-1
Adjusting idle and CO . . . . .	25-2
Testing and adjusting specifications . . . . .	25-5
Pressure tests . . . . .	25-7
Connectig and bleeding pressure gauge . . . . .	25-8
Checking system pressure . . . . .	25-10
Checking control pressure "warm" . . . . .	25-10
Checking entire fuel system for leaks . . . . .	25-11
Checking control pressure "cold" . . . . .	25-12

	Page
Checking function of hot start valve (CIS) . . . . .	25-12b
Checking hot start valve for leaks (CIS) . . . . .	25-12b
Pressure tests with VW 1318 . . . . .	25-12c
Connecting and bleeding pressure tester VW 1318 . . . . .	25-12d
Connecting and bleeding pressure tester VW 1318 . . . . .	25-12e
Checking system pressure . . . . .	25-12f
Checking control pressure "warm" . . . . .	25-12f
Checking and adjusting rest position of air flow sensor plate . . . . .	25-13
Replacing pressure relief and residual pressure valves . . . . .	25-14
Removing and installing mixture control unit . . . . .	25-15
Disassembling and assembling mixture control unit . . . . .	25-17
Disassembling and assembling mixture control unit . . . . .	25-21
Removing and installing fuel injectors . . . . .	25-23
Removing and installing oxygen sensor . . . . .	25-25
Resetting elapsed mileage switch . . . . .	25-26
Removing and installing control unit for AFC fuel injection and oxygen sensors . . . . .	25-26

### **Exhaust system/ Emission Controls**

Replacing filter element of air pump . . . . .	26-1
Checking tightness of exhaust flanges . . . . .	26-1
Hose Layout . . . . .	26-3
Intermediate and/or final mufflers - single pipe system . . . . .	26-6
Replacing intermediate and/or final mufflers . . . . .	26-7
Intermediate and/or final mufflers - twin pipe system . . . . .	26-8
Replacing intermediate muffler and final muffler . . . . .	26-9
Replacing final muffler . . . . .	26-9

### **Starter, Power Supply, Cruise Control**

Checking battery . . . . .	27-1
Automatic cruise control (tempostat) . . . . .	27-3
Removing and installing tempostat control . . . . .	27-6
Removing and installing tempostat switch (steering column switch) . . . . .	27-6
Removing and installing clutch pedal switch . . . . .	27-7
Removing and installing vacuum servo . . . . .	27-8
Removing and installing cable on vacuum servo . . . . .	27-9

	Page
Troubleshooting automatic cruise control (tempostat) . . . . .	27-10
Checking multiple pin plug of control with voltmeter or test lamp . . . . .	27-12
Checking multiple pin plug of control with ohmmeter and ignition turned off . . . . .	27-13
Removing and installing starter . . . . .	27-15
Removing and installing tempostat control unit . . . . .	27-17
Removing and installing steering column switch, actuator . . . . .	27-18
Removing and installing bowden cable . . . . .	27-19
Removing and installing clutch pedal switch . . . . .	27-20
Troubleshooting, tempostat . . . . .	27-21
Tempostat control unit pin assignment . . . . .	27-21
Testing multi-pin plug of tempostat control unit . . . . .	27-22
Alternator, removing and installing . . . . .	27-25

## Ignition system

Ignition components . . . . .	28-1
Cautions when repairing electronic ignition systems . . . . .	28-3
Adjusting ignition timing . . . . .	28-4
Distributor specifications . . . . .	28-7
Removing and installing distributor . . . . .	28-8
Replacing spark plugs . . . . .	28-9
Removing and installing vacuum unit . . . . .	28-10
Troubleshooting electronic ignition system . . . . .	28-11
Ignition components . . . . .	28-21
Ignition adjusting and testing values . . . . .	28-22
Adjusting ignition timing . . . . .	28-23
Checking ignition timing . . . . .	28-24
Checking distributor . . . . .	28-25
Equipment table . . . . .	28-31
Checking distributor . . . . .	28-34
Equipment table . . . . .	28-35
cautions when repairing electronic ignition systems . . . . .	28-39
Electronic ignition system . . . . .	28-40
Important car information . . . . .	28-44
Removing and installing electronic ignition control unit . . . . .	28-45
Removing and installing transistorized ignition control unit . . . . .	28-45
Removing and installing transistorized igniton control unit . . . . .	28-46

	Page
<b>Ignition System</b>	
Removing and installing transistorized ignition control unit . . . . .	28-46
Removing and installing speed/reference mark sensor . . . . .	28-46
Removing and installing distributor . . . . .	28-47
Removing and installing TDC sensor . . . . .	28-48
Removing and installing TDC sender . . . . .	48-48c
Troubleshooting electronic ignition system . . . . .	28-49
Equipment survey . . . . .	28-65
Replacing spark plugs . . . . .	28-67
EIK control-unit coding . . . . .	28-69
Checking the transmission protection switch (automatic transmission) . . . . .	28-71
Equipment table . . . . .	28-73
Equipment table Type 928 GT - 928 GTS (5,4 l) . . . . .	28-74
Ignition circuit temperature sensor, removing and installing . . . . .	28-75
Checking the ignition circuit monitoring relay . . . . .	28-77
DME Diagnosing / Troubleshooting . . . . .	D24/28-1
LH-Diagnosis / Troubleshooting . . . . .	D24-11
EZK-Diagnosis / Troubleshooting . . . . .	D28-1

	Page
<b>Clutch, Controls</b>	
Technical data . . . . .	30-01
Torque specifications for manual transmission, gear shift, central tube . . . . .	30-03
Technical data . . . . .	30-05
Technical data (transmission type A 28.01) . . . . .	30-08
Torque specifications . . . . .	30-09
Technical data . . . . .	30-013
Technical data (transmission type A 28.01) . . . . .	30-014
Checking clutch play . . . . .	30-1
Clutch operation . . . . .	30-1
Adjusting clutch spring . . . . .	30-1
Checking wear of clutch discs . . . . .	30-2
Bleeding clutch . . . . .	30-2a
Removing and installing clutch pedal . . . . .	20-2b
Removing and installing clutch spring . . . . .	30-2g
Removing and installing clutch . . . . .	30-3
Removing and installing clutch, single-disk clutch, '87 models onward . . . . .	30-6b
Disassembling and assembling clutch (diameter-centered) . . . . .	30-7
Disassembling and assembling clutch (dowel pin-centered) . . . . .	30-10
Disassembling and assembling clutch (diameter and dowel pin centered) . . . . .	30-17
Clutch linkage versions . . . . .	30-20
Ball stud versions . . . . .	30-21
Replacing ball stud . . . . .	30-21
Removing and installing clutch housing . . . . .	30-22
Checking clutch discs . . . . .	30-23
Checking clutch pressure plate . . . . .	30-24
Checking clutch intermediate plate . . . . .	30-24
Overhauling clutch slave cylinder . . . . .	30-25
Checking clutch disc for wear . . . . .	30-27
<b>Torque converter</b>	
Removing and installing torque converter . . . . .	32-1
<b>Manual transmission / controls, case</b>	
Changing transmission oil . . . . .	34-1
Removing and installing transmission . . . . .	34-3
Adjusting transmission suspension . . . . .	34-8a
Disassembling and assembling shift linkage . . . . .	34-8c
Disassembling and assembling transmission . . . . .	34-9
Disassembling and assembling upper case cover with reverse gear lock . . . . .	34-19

Page

**Manual transmission / Gears and shafts**

Disassembling and assembling input shaft . . . . .	35-1
Disassembling and assembling pinion shaft . . . . .	35-5
Determining shim thickness "X" . . . . .	35-11
Determining shim thickness "Y" . . . . .	35-13
Measuring Distance "Z" between input shaft and pinion shaft . . . . .	35-15
Disassembling and assembling synchronizers . . . . .	35-17
Disassembling and assembling countershaft Hub/Gears . . . . .	35-21

**Automatic transmission / Controls, Case**

Removing and installing transmission . . . . .	37-1
Removing and installing selector cable . . . . .	37-9
Removing and installing selector lever cover frame . . . . .	37-10a
Adjusting selector cable . . . . .	37-11
Cable and backup light switch operation . . . . .	37-12
Removing and installing accelerator cable . . . . .	37-13
Adjusting throttle pressure cable . . . . .	37-14
Neutral/park starting switch . . . . .	37-15
Disassembling and assembling front converter housing . . . . .	37-17
Removing and installing final drive housing . . . . .	37-21
Removing and installing rear transmission case and rear converter housing . . . . .	37-26a
Disassembling and assembling rear converter housing . . . . .	37-27
Disassembling and assembling final drive housing . . . . .	37-31
Disassembling and assembling transmission . . . . .	37-35
Disassembling and assembling transmission case . . . . .	37-45
Installing automatic transmission section . . . . .	37-53

**Automatic Transmission / Gears, Valve Body**

Checking transmission operation . . . . .	38-1
Troubleshooting . . . . .	38-11
Removing and installing valve body . . . . .	38-21
Replacing ATF and filter . . . . .	38-25
Flushing ATF cooler and lines . . . . .	38-28
Disassembling and assembling centrifugal governor . . . . .	38-29
Disassembling and assembling gear assembly . . . . .	38-33
Disassembling and assembling clutch K 1 . . . . .	38-41
Disassembling and assembling clutch K 2 . . . . .	38-47

	Page
<b>Differential / Transaxle System</b>	
Removing and installing differential . . . . .	39-1
Disassembling and assembling differential . . . . .	39-5
Adjusting pinion and ring gear . . . . .	39-11
Removing and installing final drive for automatic transmission . . . . .	39-21
Disassembling and assembling bearing assembly for automatic transmission . . . . .	39-25
Determining thickness of shims for bearing assembly . . . . .	39-29
Adjusting pinion and ring gear (automatic transmission) . . . . .	39-31
Removing and installing central tube (automatic transmission) . . . . .	39-41
Checking drive shaft (automatic transmission) . . . . .	39-49
Disassembling and assembling limited slip differential . . . . .	39-55
Removing and installing central tube (manual transmission) . . . . .	39-61
Disassembling and assembling central tube (manual transmission) . . . . .	39-63
Checking drive shaft (manual transmission) . . . . .	39-65
<b>General</b>	
5 speed manual transmission type G 28 . . . . .	30-0201
Technical data . . . . .	30-0203
Torque specifications . . . . .	30-0205
<b>Manual Transmission / Controls, Case</b>	
Disassembling and assembling transmission . . . . .	34-201
Disassembling and assembling manual transmission ('87 models onward) . . . . .	34-214a
Adjusting shift forks . . . . .	34-215
Adjusting shifts . . . . .	34-217
Adjusting gearshift ('86 models onward) . . . . .	34-218a
Adjusting gearshift ('87 models onward) . . . . .	34-218c
Disassembling and assembling upper transmission cover with reverse gear arrest . . . . .	34-219
Disassembling and assembling upper transmission cover ('87 models onward) . . . . .	34-220
Dismantling and assembling housing cover with oil pump . . . . .	34-221
Replacing O-ring for spray tube (type G28/57) . . . . .	34-223
<b>Manual Transmission / Gears and Shafts</b>	
Disassembling and assembling drive shaft . . . . .	35-201
Disassembling and assembling drive pinion . . . . .	35-205
Disassembling and assembling countershaft . . . . .	35-215
Disassembling and assembling layshaft ('87 models onward) . . . . .	35-219



	Page
<b>Differential / Transaxle System</b>	
Removing and installing differential . . . . .	39-201
Measuring the plate wear on the proportional-slip differential . . . . .	39-206a
Removing and installing the proportional-slip differential . . . . .	39-206c
Bleeding hydraulics of Porsche controlled slip differential (PSD) . . . . .	39-206i
Disassembling and assembling differential . . . . .	39-207
Limited-slip differential, disassembling and assembling (40% lock-up) . . . . .	39-212a
Dismantling and assembling the proportional-slip differential . . . . .	39-212i
Dismantling and assembling lim. slip. differential with Valeo friction discs . . . . .	39-212s
Adjusting pinion and ring gear . . . . .	39-213
Determining thickness of shim S5 . . . . .	39-215
Drive shaft and ring gear, adjusting . . . . .	39-217
Adjusting and drive pinion and ring gear . . . . .	39-219
Adjusting drive pinion and ring gear . . . . .	39-221
Adjusting drive pinion and ring gear . . . . .	39-225

PSD diagnosis / Troubleshooting: beginning with supplement 35, pages see volume III.

	Page
<b>General Data</b>	
Technical data . . . . .	30-0101
Tightening torques . . . . .	30-0105
<b>Torque Converter</b>	
Removing and installing torque converter . . . . .	32-101
Removing and installing selector lever cover frame . . . . .	37-101
Removing and installing selector lever cable . . . . .	37-103
Adjusting selector lever cable . . . . .	37-105
Removing and installing starter locking and backup light switch . . . . .	37-107
Adjusting starter locking and backup light switch . . . . .	37-109
Checking adjustment of selector lever cable and starter locking / backup light switch . . . . .	37-111
Bowden cable for control pressure, removing and installing (service solution) . . . . .	37-113
Bowden cable for control pressure, adjusting . . . . .	37-115
Removing and installing transmission . . . . .	37-117
Adjusting transmission suspension . . . . .	37-123
Disassembling and assembling front converter housing . . . . .	37-125
Disassembling and assembling front converter housing ('87 models onward) . . . . .	37-130
Removing and installing rear transmission case . . . . .	37-131
Removing and installing rear transmission . . . . .	37-135
Disassembling and assembling transmission . . . . .	37-143
<b>Transmission / Gears, Valve Body</b>	
Checking transmission operation . . . . .	38-101
Checking operation . . . . .	38-110
Checking operation (87 models onward) . . . . .	38-110a
Troubleshooting . . . . .	38-111
Removing and installing shift valve casing . . . . .	38-123
Disassembling and assembling shift valve housing . . . . .	38-125
Disassembling and assembling shift valve casing ('87 models onward) . . . . .	38-130a
Removing and installing lower cover . . . . .	38-131
Disassembling and assembling lower cover . . . . .	38-133
Replacing ATF and filter . . . . .	38-137
Flushing ATF cooler and lines . . . . .	38-141
Removing and installing governor . . . . .	38-143
Checking governor . . . . .	38-145
Removing and installing vacuum modulator . . . . .	38-147
Removing and installing primary pump . . . . .	38-149

	Page
Disassembling and assembling secondary pump . . . . .	38-155
Disassembling and assembling gear assembly . . . . .	38-157
Disassembling and assembling one-way clutch . . . . .	38-163
Disassembling and assembling clutch K 1 . . . . .	38-169
Disassembling and assembling clutch K 2 . . . . .	38-177

### **Differential / Transaxle system**

Removing and installing final drive . . . . .	39-101
Disassembling and assembling final drive . . . . .	39-107
Disassembling and assembling differential . . . . .	39-113
Disassembling and assembling bearing assembly . . . . .	39-119
Disassembling and assembling bearing assembly / Determining thickness of shims for bearing assembly . . . . .	39-123
Adjusting drive pinion and ring gear . . . . .	39-125
Adjusting drive pinion and ring gear . . . . .	39-127
Adjusting drive pinion and ring gear . . . . .	39-128
Adjusting drive pinion and ring gear . . . . .	39-130
Adjusting drive pinion and ring gear . . . . .	39-133
Adjusting drive pinion and ring gear . . . . .	39-135
Disassembling and assembling central tube . . . . .	39-137
Checking central tube . . . . .	39-139
PSD-Diagnosis / Troubleshooting . . . . .	D39-201

	Page
<b>Front wheel suspension</b>	
Technical data . . . . .	40-01
Tightening torques . . . . .	40-02
Notes on front axle, 86 models onward . . . . .	40-04
Disassembling and assembling wheel suspension . . . . .	40-1
Disassembling and assembling wheel suspension, until end of model year 85 . . . . .	40-2
Disassembling and assembling wheel suspension, 86 models onward . . . . .	40-7
Disassembling and assembling wheel suspension (before and after model year 86) . . . . .	40-13
Wheel suspension components - installation overview . . . . .	40-16
Modifications to mountings . . . . .	40-19
Closing slots in ball joints . . . . .	40-23
Inspecting protective caps of ball joints on control arms and track rods . . . . .	40-24
Modified steering knuckle, cars with floating brake calipers . . . . .	40-25
Disassembling and assembling wheel bearing . . . . .	40-27
Removing and installing spring strut . . . . .	40-35
Disassembling and assembling spring strut, tools . . . . .	40-35
Disassembling and assembling non-adjustable spring strut . . . . .	40-37
Disassembling and assembling adjustable spring strut . . . . .	40-39
Disassembling and assembling adjustable and non-adjustable spring struts . . . . .	40-42
Coil springs for adjustable spring struts . . . . .	40-46
Coil springs for non-adjustable spring struts . . . . .	40-47
Coil springs for non-adjustable struts/effect on car height . . . . .	40-49
Dampers - installation overview . . . . .	40-51
<b>Rear Wheel Suspension, Axle Shaft</b>	
Technical data . . . . .	42-01
Tightening torques . . . . .	42-02
Disassembling and assembling rear suspension . . . . .	42-1
Disassembling and assembling Hub assembly . . . . .	42-7
Replacing upper control arm mount . . . . .	42-13
Removing and installing spring strut . . . . .	42-14
Disassembling and assembling spring strut . . . . .	42-15
Damper - installation overview . . . . .	42-18d
Removing and installing axle shaft . . . . .	42-19
Disassembling and assembling axle shaft . . . . .	42-21
Removing and installing rear axle assembly . . . . .	42-29
<b>Wheels, Tires, Alignment</b>	
Wheels and tires, pressure . . . . .	44-01
17-inch wheels . . . . .	44-03
Alignment settings . . . . .	44-05

	Page
Sample measuring card . . . . .	44-06
Alignment . . . . .	44-1
Checking wheel rims . . . . .	44-6
General assembly information, tires . . . . .	44-7
Wheel balancing . . . . .	44-10
Installing and removing wheels on car . . . . .	44-19
Tire pressure warning system - General . . . . .	44-21
Tire inflation pressure for vehicles with tire pressure warning system . . . . .	44-26
Tire pressure warning system short test . . . . .	44-28
Removing and installing pressure-operated switches (tire pressure warning system) . . . . .	44-29
Removing and installing high-frequency sensor (tire pressure warning system) . . . . .	44-32
Removing and installing tire pressure warning system control unit . . . . .	44-33
Connector assignment of the control unit connector . . . . .	44-34
Notes on trouble-shooting - Tire pressure warning system . . . . .	44-35
Tire pressure warning system (RDK) diagnosis . . . . .	44-301

## Antiblock System

General . . . . .	45-01
Design - ABS . . . . .	45-03
Components - ABS . . . . .	45-04
Important notes for troubleshooting and ABS test program . . . . .	45-06
Important information for working on cars with ABS . . . . .	45-07
Removing and installing hydraulic unit . . . . .	45-1
Removing and installing electronic control unit . . . . .	45-5
Removing and installing relays . . . . .	45-6
Removing and installing sensors . . . . .	45-8
Removing and installing speed sensor, 86 models onward . . . . .	45-11

## Brakes / Mechanical

General . . . . .	46-01
Technical data . . . . .	46-02
Technical data, 86 models onward . . . . .	46-05
Torque specifications . . . . .	46-08

	Page
Technical data as of MY '92 . . . . .	46-011
Checking thicknesss of brake pads . . . . .	46-1
Removing and installing brake pads (Floating frame caliper disc brakes) . . . . .	46-2
Removing and installing brake pads (floating caliper disc brakes) . . . . .	46-5
Removing and installing brake pads (four-piston fixed caliper) . . . . .	46-6b
Removing and installing brake pedal . . . . .	46-8
Adjusting brake pressure rod (until end of model year 85) . . . . .	46-9
Adjusting brake pressure rod (86 models onward) . . . . .	46-10
Checking stoplamp switch setting . . . . .	46-10a
Disassembling and assembling front wheel brake . . . . .	46-11
Disassembling and assembling rear wheel brake . . . . .	46-13
Checking brake disc lateral runout . . . . .	46-16
Checking brake disc thickness . . . . .	46-18
Disassembling and assembling parking brake lever . . . . .	46-19
Checking and adjusting parking brake . . . . .	46-21

## Brakes / Hydraulics

Tightening torques . . . . .	47-01
Notes on brakes, 86 models onward . . . . .	47-03
Disassembling and assembling floating frame caliper . . . . .	47-1
Disassembling and assembling fist caliper . . . . .	47-7
Replacing dampers and slides . . . . .	47-12
Removing and installing brake master cylinder . . . . .	47-13
Removing and installing brake booster . . . . .	47-15
Removing and installing brake pressure regulator . . . . .	47-17
Braking-force regulators - installation overview (until end of model year 83) . . . . .	47-18a
Braking-force regulator - installation overview (84 models onward) . . . . .	47-18b
Testing braking-force regulator . . . . .	47-19
Notes on bleeding brakes and changing brake fluid . . . . .	47-22

## Steering

Technical data . . . . .	48-01
Torque specifications . . . . .	48-02
Removing and installing steering gear . . . . .	48-1
Steering stop versions . . . . .	48-6a
Removing and installing power steering pump . . . . .	48-7
Replacing seals for aluminium power steering pump . . . . .	48-8a
Notes on power steering: . . . . .	48-8i
Checking drive belt tension . . . . .	48-8i
Checking steering system for leaks . . . . .	48-8j

## Page

Bleeding steering system . . . . .	48-8k
Checking hydraulic function of steering (pressure test) . . . . .	48-9
Removing and installing steering wheel . . . . .	48-14
Repairing steering and intermediate shafts with steering tube . . . . .	48-15
Replacing upper steering shaft bearing . . . . .	48-30
Dismantling and assembling steering wheel height adjuster of airbag vehicles . . . . .	48-33

**Heater**

Heater, blower, air distribution housing . . . . .	80-1
--	------

**Air Conditioner**

Specifications . . . . .	87-01
Tightening torques . . . . .	87-02
Refrigerant system layout . . . . .	87-1
Vacuum system layout . . . . .	87-2
Safety regulations for handling refrigerant R12 . . . . .	87-3
Installation work on the air-conditioning system (Service unit SECU) . . . . .	87-4b
Removing and installing heater / evaporator . . . . .	87-5
Removing and installing blower . . . . .	87-16
Removing and installing air distribution housing . . . . .	87-17
Disassembling and assembling heater / evaporator . . . . .	87-19
Removing and installing condenser fan . . . . .	87-24
Removing and installing receiver-drier . . . . .	87-25
Removing and installing compressor . . . . .	87-28
Disassembling and assembling compressor . . . . .	87-31
Regulators and control unit of automatic air conditioner . . . . .	87-43
Disassembling and assembling center vent and switch . . . . .	87-47
Automatic air conditioner 84 models onward . . . . .	87-89
Technical data . . . . .	87-90
Tightening torques . . . . .	87-91
Disassembling and assembling heater / air conditioner . . . . .	87-92
Removing and installing heater / air conditioner . . . . .	87-97
Removing and installing compressor . . . . .	87-99
Removing and installing condenser . . . . .	87-100
Removing and installing fluid tank . . . . .	87-101
Removing and installing antifreeze unit . . . . .	87-102
Removing and installing expansion valve / Distribution of oil in refrigeration circuit . . . . .	87-103
Vacuum system - schema . . . . .	87-104
Checking vacuum system . . . . .	87-105
Flap position program . . . . .	87-106
Checking flap position program . . . . .	87-108
Checking operating switch . . . . .	87-110
Testing setting motor . . . . .	87-113

---

	Page
Adjusting temperature mixture flaps . . . . .	87-115
Pressure and temperature specifications . . . . .	87-116
Troubleshooting . . . . .	87-118
Auxiliary air conditioner . . . . .	87-120
Removing and installing magnetic clutch . . . . .	87-126
Technical Data of air conditioning system as of MY '93 . . . . .	87-129



	Page
<b>Body - General</b>	
Special tools and shop materials for body repairs . . . . .	50-01
Repair dimensions . . . . .	50-03
Safety notes . . . . .	50-05
<b>Body-Front Section</b>	
Replacing part of front wheelhouse . . . . .	50-1
Replacing front end partially . . . . .	50-5
Modifications on body front end . . . . .	50-9
<b>Body-Center Section</b>	
Replacing rocker panel . . . . .	51-1
<b>Body-Rear Section</b>	
Replacing rear apron and quarter panel . . . . .	53-1
Replacing quarter panel end section . . . . .	53-5
Body repairs to foam-filled cavities . . . . .	53-7
<b>Lids</b>	
Removing and installing engine hood cable . . . . .	55-1
Replacing latch on rear lid lock (upper section) . . . . .	55-3
Removing and installing electric rear lid unlocking device . . . . .	55-5
<b>Doors</b>	
Removing and installing door . . . . .	57-1
Removing and installing door window and regulator . . . . .	57-3
Removing and installing door lock . . . . .	57-6
Checking door central locking system . . . . .	57-7
Replacing door lock cylinder . . . . .	57-15
Modification to rotary knob lock . . . . .	57-17
Modification on unfinished shell . . . . .	57-19
Troubleshooting central locking system - from 1980 models . . . . .	57-21
Changes on doors and door lock cylinders . . . . .	57-25
<b>Sun roof</b>	
Removing and installing power sun roof . . . . .	60-1
Removing and installing drive motor and gearbox for sun roof . . . . .	60-4
Removing and installing wind deflector for sun roof . . . . .	60-5
Removing and installing gates, guide, cables and guide rails . . . . .	60-6
Modifications on sun roof . . . . .	60-8

	Page
<b>Bumpers</b>	
Removing and installing bumper . . . . .	63-2
Removing and installing nose panel, '87 models onward . . . . .	63-4a
Disassembling and assembling bumpers . . . . .	63-5
Removing and installing bumper . . . . .	63-6
<b>Glases, Window Control</b>	
Removing and installing power window operating switch . . . . .	64-1
Installing adhesive plate for inside rear view mirror . . . . .	64-2
Bonding the interior rearview mirror in place . . . . .	64-2a
Removing and installing windshield . . . . .	64-3
Removing and installing the bonded windshield . . . . .	64-7
Removing and installing the bonded rear side window . . . . .	64-15
Removing and installing windshield - 2-pack adhesive . . . . .	64-21
Removing and installing bonded rear side window - 2-pack adhesive . . . . .	64-31
<b>Exterior Equipment</b>	
Paint colors from 1978 models . . . . .	66-01
Paint colors from 1980 models . . . . .	66-02
Body paint colors from 1982 models . . . . .	66-03
Body paint colors from 1984 models . . . . .	66-04
Body paint colors from 1985 models . . . . .	66-05
Body paint colors, '86 models onward . . . . .	66-06
Body paint colors '87 models onward . . . . .	66-07
Body paint colors - 1989 models onward . . . . .	66-08
Body paint colors - 1990 models onward . . . . .	66-09
Body paint colors - 1991 models onward . . . . .	66-010
Body paint colors - 1992 models onward . . . . .	66-011
Removing and installing side guard strips . . . . .	66-1
Service installing side guard strips . . . . .	66-3
Removing and installing front spoiler . . . . .	66-5
Removing and installing rear spoiler . . . . .	66-9
Removing and installing outside mirror . . . . .	66-13
Service installing outside mirror on passenger's door . . . . .	66-15
Removing and installing sill covers . . . . .	66-20
Removing and installing rear spoiler . . . . .	66-25
Removing and installing front air dam . . . . .	66-27
Fitting the CLUB SPORT emblem . . . . .	66-29
Retrofitting new mirror generation for vehicles as of MY '87 . . . . .	66-31

	Page
<b>Interior Equipment</b>	
Removing and installing rear side trim panel . . . . .	68-1
Safety regulations for handling airbag vehicles . . . . .	68-3
Removing and installing the airbag steering wheel . . . . .	68-5
Removing and installing airbag components . . . . .	68-6
Checking the airbag system to ensure that long-term functioning is guaranteed . . . . .	68-11
Checking the safety belts . . . . .	68-13
Correct disposal of airbag units . . . . .	68-15
Diagnosis/Troubleshooting Airbag . . . . .	D68 - 1
<b>Seats</b>	
Removing and installing power seat . . . . .	72-1
Removing seat backrest motor . . . . .	72-3
Disassembling seat controls . . . . .	72-4
Disassembling left seat track and removing fore / aft seat control motor . . . . .	72-5
Disassembling right seat track and removing seat height control motor . . . . .	72-6
Seat and mirror position control system . . . . .	72-7
Seat and mirror position control system, method of operation . . . . .	72-9
Seat control unit, plug assignment . . . . .	72-11
Checking seat and mirror position control system . . . . .	72-13
Plug assignment, mirror control unit . . . . .	72-17
Checking mirror control unit . . . . .	72-19
Checking control panel . . . . .	72-22
Electrically adjustable seat . . . . .	72-23
Calibrating controllable seat heating . . . . .	72-31
Checking seat heating . . . . .	72-33
<b>Instruments, Fuel Gauge, Alarm System</b>	
Precautions when working on cars with electronic control units . . . . .	90-01
Location of relays and electronic controls in car . . . . .	90-1
Removing and installing instrument cluster . . . . .	90-7
Disassembling and assembling instrument cluster . . . . .	90-8
Removing and installing clock . . . . .	90-10
Troubleshooting car radio . . . . .	90-11
Measuring antenna resistance . . . . .	90-17
Removing trim plate for radio opening . . . . .	90-18
Instrument cluster as from 1979 models . . . . .	90-19
Location of fuses and relays in car - 1980 model . . . . .	90-20
Removing and installing radio (digital radio Bamberg QTS) . . . . .	90-25
Checking fuel consumption indicator . . . . .	90-27
Troubleshooting central warning system . . . . .	90-29
Troubleshooting central warning system / Function test on central warning unit . . . . .	90-31