

# Quick Reference Guide

<b>General Information</b>	<b>1</b>
<b>Periodic Maintenance</b>	<b>2</b>
<b>Fuel System</b>	<b>3</b>
<b>Cooling System</b>	<b>4</b>
<b>Engine Top End</b>	<b>5</b>
<b>Clutch</b>	<b>6</b>
<b>Engine Lubrication System</b>	<b>7</b>
<b>Engine Removal/Installation</b>	<b>8</b>
<b>Crankshaft/Transmission</b>	<b>9</b>
<b>Wheels/Tires</b>	<b>10</b>
<b>Final Drive</b>	<b>11</b>
<b>Brakes</b>	<b>12</b>
<b>Suspension</b>	<b>13</b>
<b>Steering</b>	<b>14</b>
<b>Frame</b>	<b>15</b>
<b>Electrical System</b>	<b>16</b>
<b>Appendix</b>	<b>17</b>

This quick reference guide will assist you in locating a desired topic or procedure.

- Bend the pages back to match the black tab of the desired chapter number with the black tab on the edge at each table of contents page.
- Refer to the sectional table of contents for the exact pages to locate the specific topic required.

# 1-8 GENERAL INFORMATION

## Model Identification

ZX636-B1 (Ninja ZX-6R) Left Side View:



ZX636-B1 (Ninja ZX-6R) Right Side View:

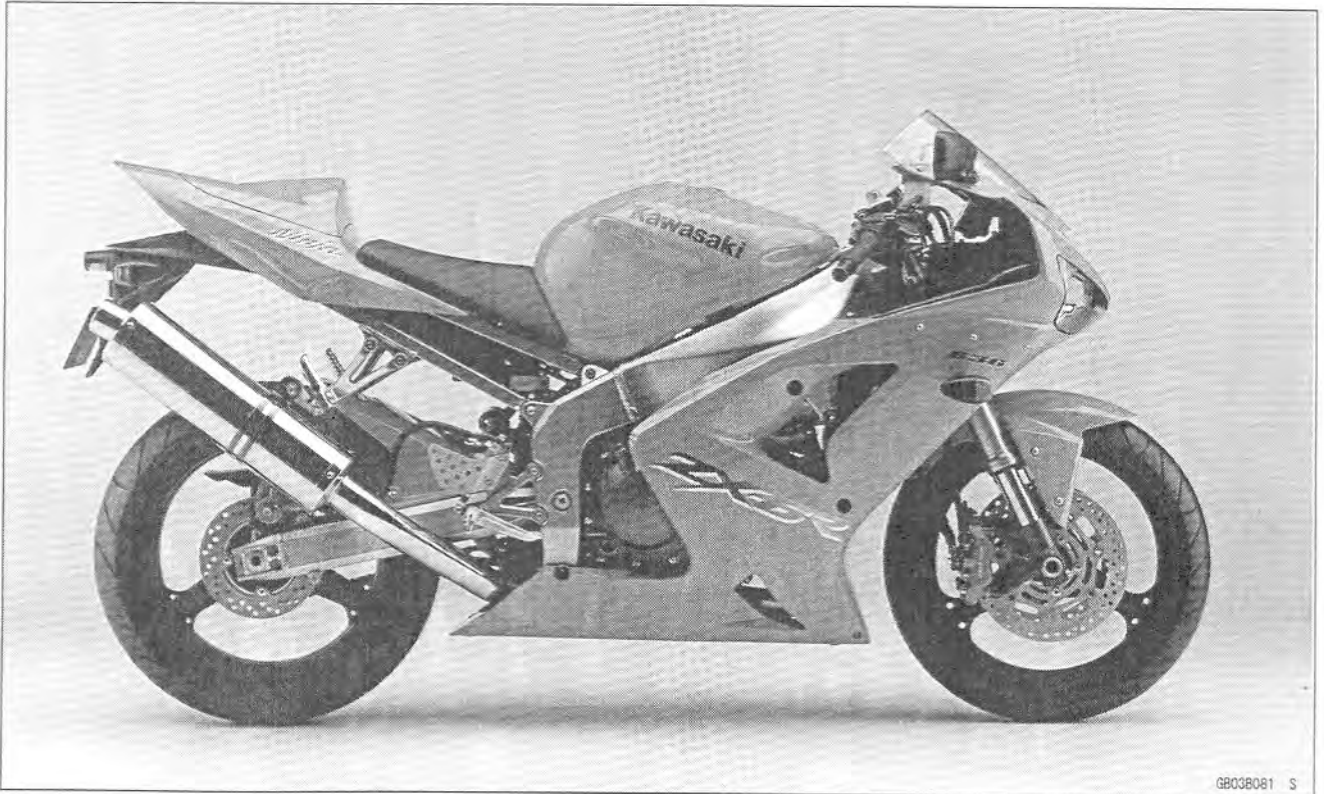

Model Identification

ZX600-K1 (Ninja ZX-6RR) Left Side View:



ZX600-K1 (Ninja ZX-6RR) Right Side View:



# 1-10 GENERAL INFORMATION

## General Specifications

Items	ZX636-B1 (Ninja ZX-6R)
<b>Dimensions:</b>	
Overall length	2 025 mm (79.7 in.)
Overall width	720 mm (28.3 in.)
Overall height	1 100 mm (43.3 in.)
Wheelbase	1 400 mm (55.1 in.)
Road clearance	130 mm (5.1 in.)
Seat height	825 mm (32.4 in.)
Dry mass	161 kg (1579 N, 355 lb)
Curb mass: Front	95 kg (932 N, 209 lb)
Rear	93 kg (912 N, 205 lb)
Fuel tank capacity	18 L (4.76 US gal)
<b>Performance:</b>	
Minimum turning radius	3.3 m (10.8 ft)
<b>Engine:</b>	
Type	4-stroke, DOHC, 4-cylinder
Cooling system	Liquid-cooled
Bore and stroke	68.0 x 43.8 mm (2.6 x 1.7 in.)
Displacement	636 mL (38.8 cu in.)
Compression ratio	12.8
Maximum horsepower	87.0 kW (118 PS) @13 000 r/min (rpm), (AU) 84.2 kW (114 PS) @12 000 r/min (rpm), (FR) 78.2 kW (106 PS) @12 500 r/min (rpm), (US), (CAL), (CA) ---
Maximum torque	67.0 N·m (6.8 kgf·m, 49 ft·lb) @11 000 r/min (rpm), (US), (CAL), (CA), (FR) ---
Carburetion system	FI (Fuel Injection), KEIHIN TTK-38 × 4
Starting system	Electric starter
Ignition system	Battery and coil (transistorized)
Timing advance	Electronically advanced (digital igniter in ECU)
Ignition timing	From 12.5° BTDC @1 300 r/min (rpm) to 35° BTDC @4 600 r/min (rpm)
Spark plug	NGK CR9E
Cylinder numbering method	Left to right, 1-2-3-4
Firing order	1-2-4-3
Valve timing:	
Inlet	Open
	Close
	Duration
Exhaust	Open
	Close
	Duration
Lubrication system	Forced lubrication (wet sump with cooler)



## General Specifications

Items	ZX636-B1 (Ninja ZX-6R)
Engine oil: Type Viscosity Capacity	API SE, SF or SG API SH or SJ with JASO MA SAE10W-40 4.0 L (4.2 US qt)
<b>Drive Train:</b> Primary reduction system: Type Reduction ratio Clutch type Transmission: Type Gear ratios: 1st 2nd 3rd 4th 5th 6th Final drive system: Type Reduction ratio Overall drive ratio	Gear 2.022 (89/44) Wet multi disc 6-speed, constant mesh, return shift 2.923 (38/13) 2.055 (37/18) 1.722 (31/18) 1.450 (29/20) 1.272 (28/22) 1.153 (30/26) Chain drive 2.666 (40/15) 6.223 @Top gear
<b>Frame:</b> Type Caster (rake angle) Trail Front tire:    Type Size Rear tire:    Type Size Front suspension: Type Wheel travel Rear suspension: Type Wheel travel Brake Type:   Front Rear	Tubular, diamond 24.5° 95 mm (3.7 in.) Tubeless 120/65 ZR17 M/C (56W) Tubeless 180/55 ZR17 M/C (73W) Telescopic fork (upside-down) 120 mm (4.7 in.) Swingarm (uni-trak) 135 mm (5.3 in.) Dual discs Single disc
<b>Electrical Equipment:</b> Battery	12 V 8 Ah

# 1-12 GENERAL INFORMATION

## General Specifications

Items	ZX636-B1 (Ninja ZX-6R)
Headlight:	
Type	Semi-sealed beam
Bulb	12 V 55 W (quartz-halogen) × 2
Hi	12 V 55 W (quartz-halogen)
Lo	12 V 0.5/3.8 W (LED)
Tail/brake light	(US), (CAL), (CA) 12 V 0.5/5 W (LED)
Alternator:	
Type	Three-phase AC
Rated output	22.5 A / 14 V @5 000 r/min (rpm)

Specifications subject to change without notice, and may not apply to every country.

(US): United States Model

(CAL): California Model

(CA): Canada Model

(AU): Australia Model

(FR): France Model

## General Specifications

Items	ZX600-K1 (Ninja ZX-6RR)
<b>Dimensions:</b> Overall length Overall width Overall height Wheelbase Road clearance Seat height Dry mass Curb mass:     Front Rear Fuel tank capacity	2 025 mm (79.7 in.) 720 mm (28.3 in.) 1 100 mm (43.3 in.) 1 400 mm (55.1 in.) 130 mm (5.1 in.) 825 mm (32.4 in.) 161 kg (1579 N, 355 lb) 95 kg (932 N, 209 lb) 93 kg (912 N, 205 lb) 18 L (4.76 US gal)
<b>Performance:</b> Minimum turning radius	3.3 m (10.8 ft)
<b>Engine:</b> Type Cooling system Bore and stroke Displacement Compression ratio Maximum horsepower  Maximum torque  Carburetion system Starting system Ignition system Timing advance Ignition timing  Spark plug Cylinder numbering method Firing order Valve timing: Inlet            Open Close Duration Exhaust        Open Close Duration  Lubrication system	4-stroke, DOHC, 4-cylinder Liquid-cooled 67.0 x 42.5 mm (2.6 x 1.7 in.) 599 mL (36.6 cu in.) 13.0 83.1 kW (113 PS) @13 200 r/min (rpm), (FR) 78.2 kW (106 PS) @13 000 r/min (rpm), (US), (CAL), (CA) --- 64.4 N·m (6.6 kgf·m, 47.5 ft·lb) @12 000 r/min (rpm), (US), (CAL), (CA), (FR) --- FI (Fuel Injection), KEIHIN TTK-38 x 4 Electric starter Battery and coil (transistorized) Electronically advanced (digital igniter in ECU) From 12.5° BTDC @1 300 r/min (rpm) to 35° BTDC @4 600 r/min (rpm) NGK CR9E Left to right, 1-2-3-4 1-2-4-3 55° BTDC 85° ABDC 320° 62° BBDC 34° ATDC 276° Forced lubrication (wet sump with cooler)

# 1-14 GENERAL INFORMATION

## General Specifications

Items	ZX600-K1 (Ninja ZX-6RR)
Engine oil: Type  Viscosity Capacity	API SE, SF or SG API SH or SJ with JASO MA SAE10W-40 4.0 L (4.2 US qt)
<b>Drive Train:</b> Primary reduction system: Type Reduction ratio Clutch type Transmission: Type Gear ratios: 1st 2nd 3rd 4th 5th 6th  Final drive system: Type Reduction ratio Overall drive ratio	Gear 2.022 (89/44) Wet multi disc  6-speed, constant mesh, return shift  2.923 (38/13) 2.055 (37/18) 1.722 (31/18) 1.450 (29/20) 1.272 (28/22) 1.153 (30/26)  Chain drive 2.666 (40/15) 6.223 @Top gear
<b>Frame:</b> Type Caster (rake angle) Trail Front tire:     Type Size Rear tire:     Type Size Front suspension: Type Wheel travel Rear suspension: Type Wheel travel Brake Type:   Front Rear	Tubular, diamond 24.5° 95 mm (3.7 in.) Tubeless 120/65 ZR17 M/C (56W) Tubeless 180/55 ZR17 M/C (73W)  Telescopic fork (upside-down) 120 mm (4.7 in.)  Swingarm (uni-trak) 135 mm (5.3 in.)  Dual discs Single disc
<b>Electrical Equipment:</b> Battery	12 V 8 Ah



## General Specifications

Items	ZX600-K1 (Ninja ZX-6RR)
Headlight:	
Type	Semi-sealed beam
Bulb	Hi 12 V 55 W (quartz-halogen) × 2
	Lo 12 V 55 W (quartz-halogen)
Tail/brake light	12 V 0.5/3.8 W (LED)
	(US), (CAL), (CA) 12 V 0.5/5 W (LED)
Alternator:	Type Three-phase AC
	Rated output 22.5 A / 14 V @5 000 r/min (rpm)

Specifications subject to change without notice, and may not apply to every country.

(US): United States Model

(CAL): California Model

(CA): Canada Model

(FR): France Model

# 1-16 GENERAL INFORMATION

## Technical Information – Air Inlet System

### Center Ram Air Inlet

The ram air duct was moved from both left and right side to center of the fairing so that incoming air has a straighter path to the airbox, increasing ram air efficiency. The duct was also designed to maintain optimum airflow despite extreme changes in bike attitude, such as during hard acceleration, braking, and cornering. With fewer parts and the duct also acting as the instrument, the new system also cuts weight.

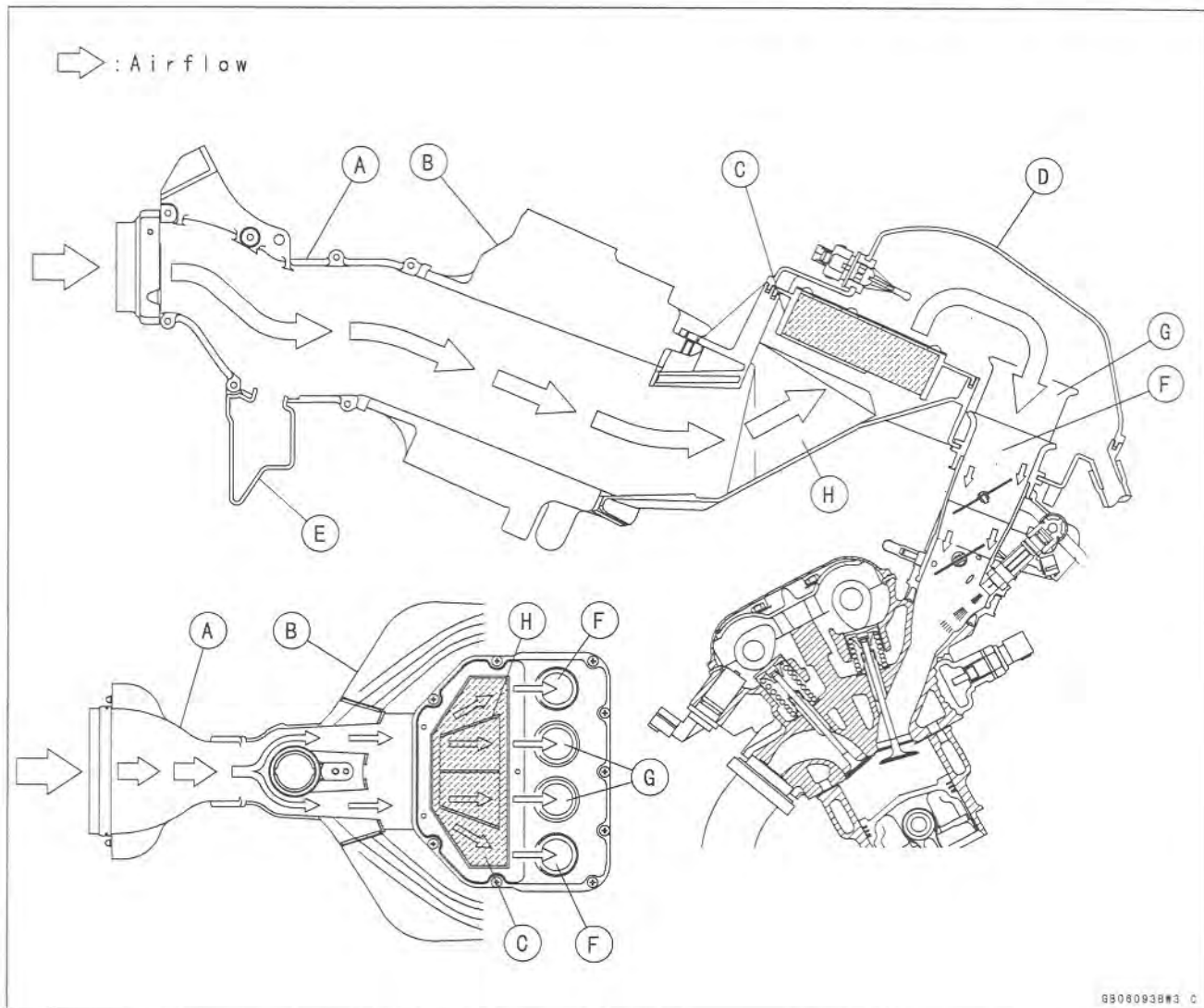
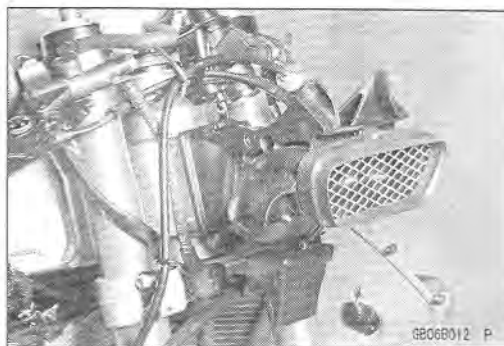

6B06B012 P

6B08093B#3 C

- A. Inlet Duct
- B. Frame
- C. Air Cleaner Element
- D. Air Cleaner Housing

- E. Resonator
- F. Air Duct #1, 4 (Short)
- G. Air Duct #2, 3 (Long)
- H. Guide Vane